

# 塩南町Y月極駐車場 配置図

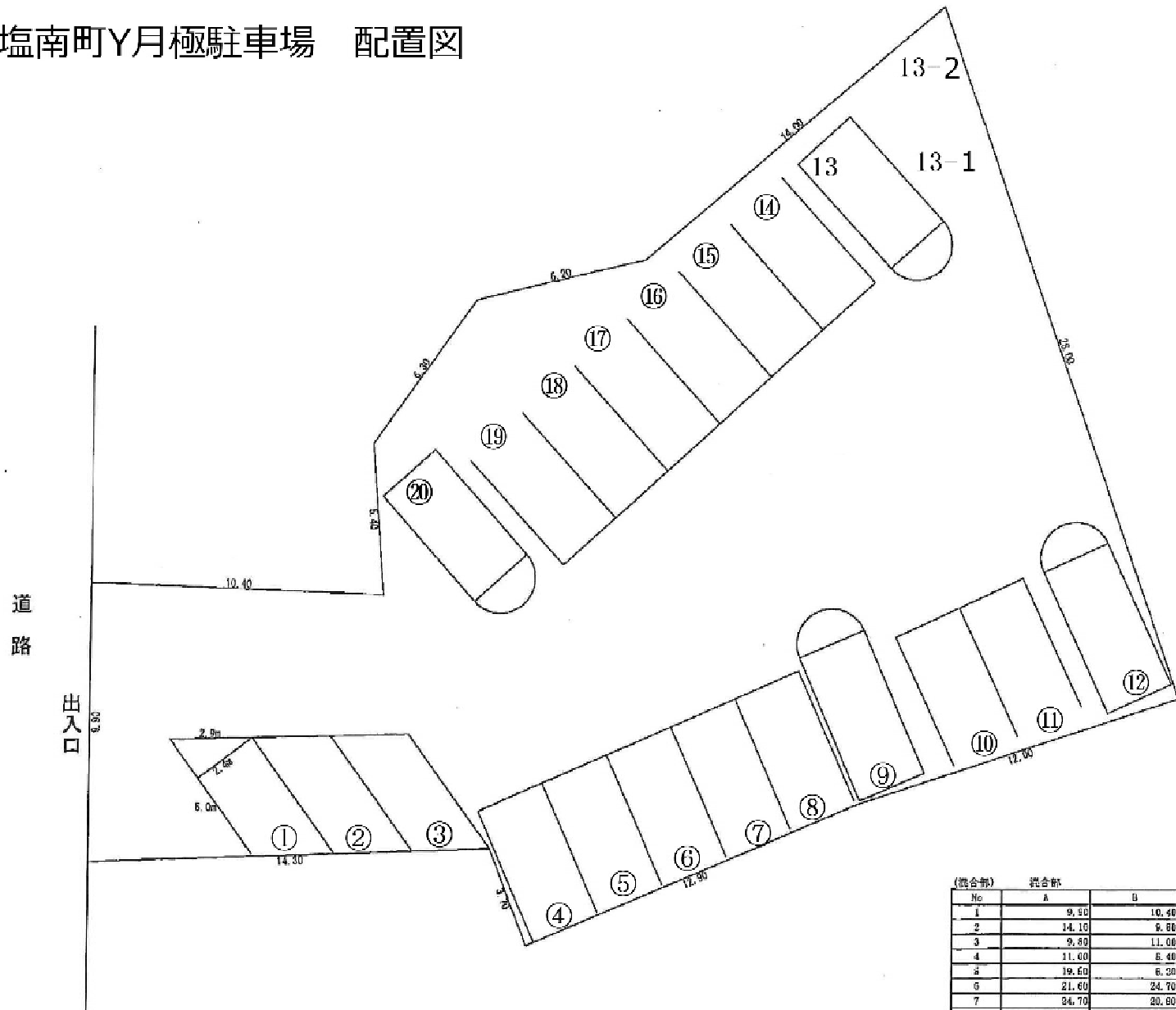
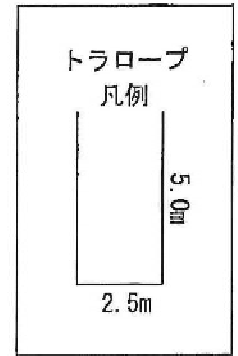

(混合部) 混合部

No	A	B	C	D	面積
1	9.50	10.40	14.10	17.200	51.46
2	14.10	9.50	14.30	19.100	65.29
3	9.50	11.00	10.60	20.150	35.22
4	11.00	8.40	6.30	11.350	16.93
5	19.40	6.00	21.80	23.850	59.23
6	21.60	24.70	3.70	25.000	29.51
7	24.70	20.60	12.00	29.250	134.13
8	29.80	24.70	12.00	28.750	124.57
9	24.70	14.00	29.00	32.350	168.81
合計					673.91